



7 Arundel Court, West Street, Burgess Hill, RH15 8NL

£1,000 Per month

Greenways Property are pleased to offer this newly refurbished one double bedroom Property. The apartment has been re-decorated throughout and also benefits from newly fitted heaters, new carpets and new double glazing. There is also a new kitchen and bathroom. The double bedroom has built in storage.

Externally there is unallocated parking and communal gardens. Burgess Hill town centre is close as is the mainline railway station.

Communal Hall

Door entry phone system with door to communal hall and stairs to first floor.

Reception Room

18'9 x 11' (5.72m x 3.35m)

This spacious room has a southerly aspect double glazed window overlooking the front, new carpets and new electric heater. Door entry phone.

Inner Hall

6'7 x 3' (2.01m x 0.91m)

Doors leading to all rooms. Two storage cupboards with one housing the hot water cylinder and electricity consumer unit.

Bedroom

8'11 x 8'9 (2.72m x 2.67m)

Double glazed window to the rear, built in wardrobe and wall mounted heater.

Kitchen

8'8 x 5'11 (2.64m x 1.80m)

Newly fitted kitchen with floor and wall mounted units. Work top with sink and drainer with mixer tap. Double oven with hob and extractor fan over. Space for fridge freezer and space for washing machine

Bathroom

6'4 x 6'3 (1.93m x 1.91m)

Newly fitted white bathroom suite comprising, panelled bath with separate shower over, low level lavatory and pedestal wash basin. Electric heated towel rail and extractor fan

Parking

Unallocated parking to the rear.

Other Information

UNFURNISHED

AVAILABLE DATE: 28th August 2024

COUNCIL TAX BAND: Tax band B

LOCAL AUTHORITY: Mid Sussex

PARKING: Unallocated Parking

DEPOSIT: £1,153.84

TENACY LENGTH: 12 Months + (Pref)

Floor Plan

FIRST FLOOR
441 sq.ft. (41.0 sq.m.) approx.

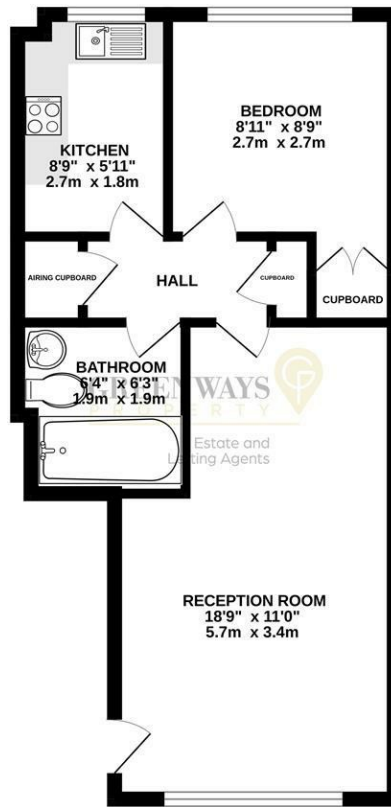

TOTAL FLOOR AREA : 441 sq.ft. (41.0 sq.m.) approx.

Whilst every attempt has been made to ensure the accuracy of the floorplan contained here, measurements of doors, windows, rooms and any other items are approximate and no responsibility is taken for any error, omission or mis-statement. This plan is for illustrative purposes only and should be used as such by any prospective purchaser. The services, systems and appliances shown have not been tested and no guarantee as to their operability or efficiency can be given. Made with Metropix ©2024

Area Map

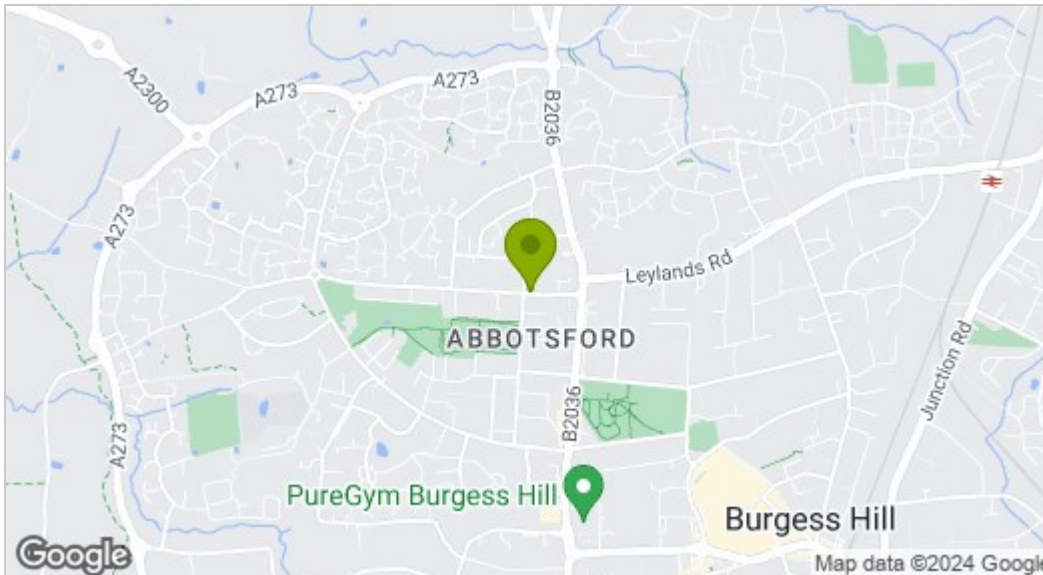

Energy Efficiency Graph

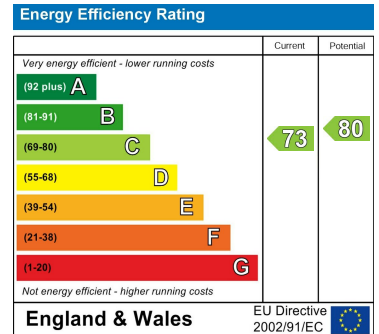

PLEASE NOTE:

Although every care has been taken in the production of these sales particulars prospective purchasers should note:

1. All measurements are approximate - floor plans included - no responsibility is taken for errors, omissions, or misstatements. The plan is for illustrative purposes only and should be used as such by a prospective purchaser.
2. Services to the property, appliances, fixtures and fittings included in the sale are believed to be in working order (though they have not been checked).
3. Prospective purchasers are advised to arrange their own tests and/or surveys before proceeding with a purchase.
4. The agents have not checked the deeds to verify the boundaries. Intending purchasers should satisfy themselves via their solicitors as to the actual boundaries of the property. None of the descriptions whatsoever forms any part of the contract for this property and is not guaranteed in any way whatsoever to be correct. It cannot be assumed by omission that any planning permissions or building regulations have been obtained for this property. Also, any planning permissions/building regulations claimed to be correct are also not guaranteed.

Greenways Property, Shoreham-by-Sea, West Sussex, BN43 6HR
Tel: 01273 28 68 98 Email: info@greenwaysproperty.com www.greenwaysproperty.com